



Prototype Elementary School Capacity Analysis

Initial planning of prototype elementary schools in SPLOST IV conceived these schools to have a capacity of 900 students, which would be 58 Instructional Units (IUs) using Ga DOE capacity calculations. During the design of the prototype elementary school, the number of IUs was increased from 58 to 59, making the Ga DOE capacity around 913 FTE (Full Time Equivalent students). See Table 1 below.

Table 1 – # of IU's and GA DOE Capacity

Instructional Units (IU)	State Capacity
58	900
59	913
60	925
61	950

While the school was designed to have only 59 IUs, the design by CGLS Architects also includes seven “flex” spaces that are smaller than a classroom, but still large enough to have some instructional use. Two of these spaces are large enough to exceed the Ga DOE's size requirements for a classroom (requires 600 sf., spaces are 630 sf. or more) see *Table 2* below. Moreover, both the room uses identified on the architect's design ("Study") and a survey DCSD schools that have already opened with this design show these spaces as being used for instruction. Because of this, the Ga DOE recognizes these spaces as IUs for a total of 61 IUs, and therefore the overall FTE capacity of the school as 950 (61 IUs).

Below is a table of the prototype design by level showing the number of Classrooms (CRs), Core IUs (gym & media center), the rooms designed as “flex” spaces but large enough to be counted as IUs (Large Flex), the total number of IUs, and the number of “flex” spaces that are too small to be counted as an IU (Small Flex). A floorplan of the elementary school prototype is attached that details each space in the design.

Table 2 – Prototype Room Summary

	CRs	Core IUs	Large Flex	IUs	Small Flex
Main Floor	25	2	0	27	3
Lower Floor	19	0	2	21	0
Second Floor	13	0	0	13	2
Total	57	2	2	61	5

Unlike the Ga DOE's capacity calculation, which only takes into account the total number of classrooms, the District uses a “Instructional Use Model” to calculate a schools capacity. In this model, the use of each instructional space affects the overall capacity of the school, and capacity can change as the use of instructional space within the school changes. Using this

model and the room uses identified on the architect's prototype design, the attached New Prototype Elementary School Capacity Report as Designed shows the DCSD capacity of the elementary prototype as designed. However, the room uses on the architect's design are not indicative of how principals of schools with the prototype design actually use these spaces. The observed room use and capacity of schools once they have opened is often different than what is shown on the architect's design.

As of 2019, five elementary schools (Rockbridge ES, Fernbank ES, John Lewis ES, Barack Obama ES, and Peachcrest ES) have opened with the current prototype design. When reviewing the capacity of these schools, Planning Department staff work with principals to determine how each classrooms and instructional space is used, which in turn affects the available capacity of the school. Attached are the reports of each of the schools listed above as well as the New Prototype Elementary School Capacity Report as Used. The instructional capacity of the prototype design as shown in the report is supported by the average instructional capacity of the five open prototype elementary schools listed above. See Table 3 below.

Table 3 – DCSD Capacity Calculated for Prototype ES

School	DSCD Capacity
Rockbridge ES	1084
Barack H. Obama EMST	1086
Fernbank ES	950
Peachcrest ES	1086
John Lewis ES	989
Average	1039

Despite the available capacity observed in the prototype design, when opening a new prototype elementary school the District uses 950 as the school's capacity to be conservative and ensure that a new school is not inadvertently overcrowded if the school opens with more students than forecasted.

Below is a breakdown of how the room counts were applied to the New Prototype Elementary School Capacity Report as Used. This breakdown of the report is calculated by examining the 5 prototype schools room size and usage.

- R01 - **Preschool**: 2 rooms are the standard count across the five schools
- R02 – **Kindergarten**: 10 rooms are an average number for kindergarten classrooms
- R03 – **General classrooms (G 1-3)**: 15 rooms assigns each grade an equal amount of 5 classrooms

- R04 – **General classrooms (G 4-5)**: 8 rooms assigns both grades an equal amount of 4 classrooms
- R05 – **K-5 Gifted**: 6 rooms based on the current usage of R05 rooms across the prototype schools thus far
- R06 – **K-5 Early Intervention EIP**: 6 rooms based on the current usage of R06 rooms across the prototype schools thus far
- R07 – **K-5 SpED**: 2 rooms based on the current usage of R07 rooms across the prototype schools thus far
- R08 – **PK-5 SpED**: 2 rooms based on the current usage of R08 rooms across the prototype schools thus far
- R09 – **K-3 ESOL**: 0 Rooms based on the current usage of R09 rooms across the prototype schools thus far
- R10 – **4-5 ESOL**: 0 Rooms based on the current usage of R10 rooms across the prototype schools thus far
- R11 – **K-5 Resource/Pull out**: 7 Rooms based on the current usage of R011 rooms across the prototype schools thus far
- R12 – **K-5 Science/STEM**: Remains consistent with previous DSCD instructional capacity reports
- R13 – **Computer Lab (ESOL computer lab)**: Remains consistent with previous DSCD instructional capacity reports
- R14 – **K-5 Music/Band/Strings**: Remains consistent with previous DSCD instructional capacity reports
- R15 – **K-5 Art**: Remains consistent with previous DSCD instructional capacity reports
- R16 – **K-5 Physical Education**: Remains consistent with previous DSCD instructional capacity reports
- R17 – **K-5 Media Center**: Remains consistent with previous DSCD instructional capacity reports
- R17.1 – **K-5 Non-Instructional Use**: Remains consistent with previous DSCD instructional capacity reports

BUILDING INFORMATION			
BUILDING #	CONSTRUCTION DATE	SQ.FT.	IU
2010 - MAIN	2015	71,669	27
2010 - LOWER LEVEL	2015	29,775	21
2010 - SECOND	2015	17,467	13
TOTAL		118,911	61

Plus 5 Flex Spaces

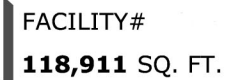

PROTOTYPE ELEMENTARY FACILITY

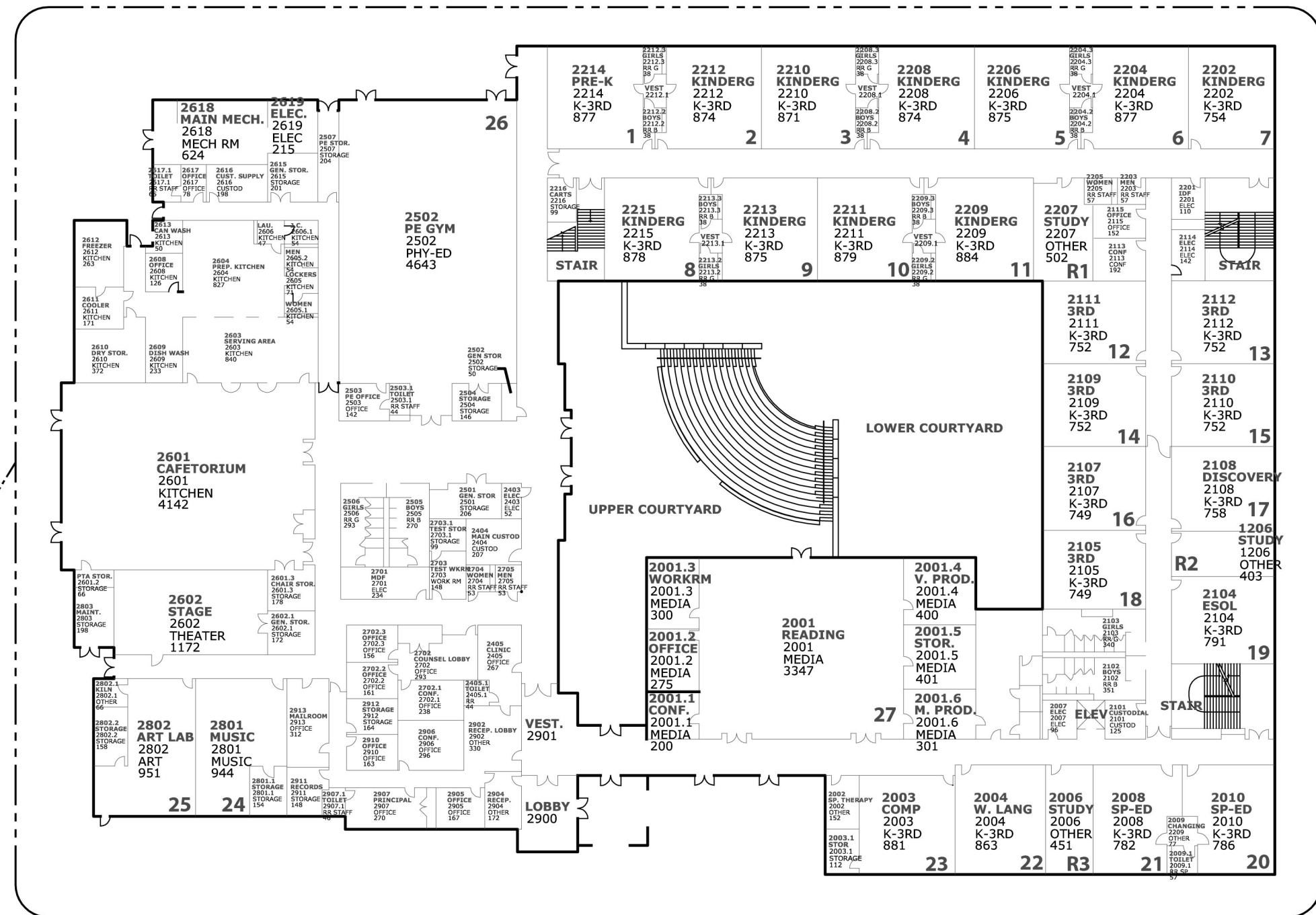

The diagram illustrates three types of building outlines used in the software:

- BUILDING OUTLINE:** A large rectangle with a dashed line on the top and bottom edges, and a small tab on the right side.
- ROOM OUTLINE:** A smaller rectangle with a solid line on the top and bottom edges, and a small tab on the right side.
- BUILDING LABEL:** A label box with a dashed line on the top and bottom edges, and a small tab on the right side. It contains the text:
 - XXXX
 - XXXX
 - XX,XXX SF

ROOM LABELS
POSTED ROOM NUMBER
ROOM / SPACE NAME
DOE SPACE NUMBER
DOE SPACE TYPE
SQUARE FOOTAGE

NOT TO SCALE



UPDATED: 7/22/2015 BY: JM

BUILDING INFORMATION			
BUILDING #	CONSTRUCTION DATE	SQ.FT.	IU
2010 - MAIN	2015	71,669	27
2010 - LOWER LEVEL	2015	29,775	21
2010 - SECOND	2015	17,467	13
TOTAL		118,911	61

Plus 3 Flex Spaces
0 Flex Spaces
Plus 2 Flex Spaces
Plus 5 Flex Spaces

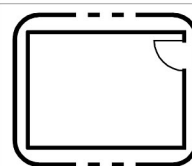

BUILDING OUTLINE

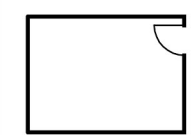

ROOM OUTLINE

XXXX

XXXX

XX,XXX SF

BUILDING LABEL
BUILDING NUMBER
YEAR BUILT
BUILDING SQ. FT.

ROOM LABELS
POSTED ROOM NUMBER
ROOM / SPACE NAME
DOE SPACE NUMBER
DOE SPACE TYPE
SQUARE FOOTAGE

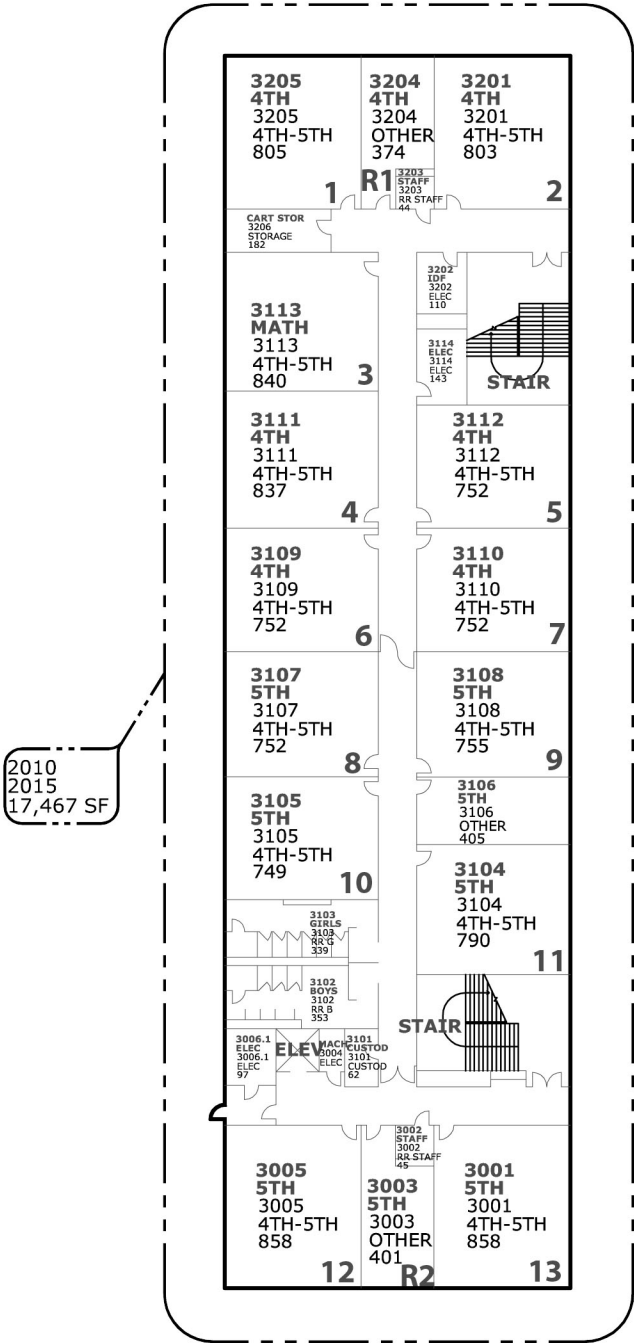

SECOND LEVEL FLOOR PLAN
NOT TO SCALE

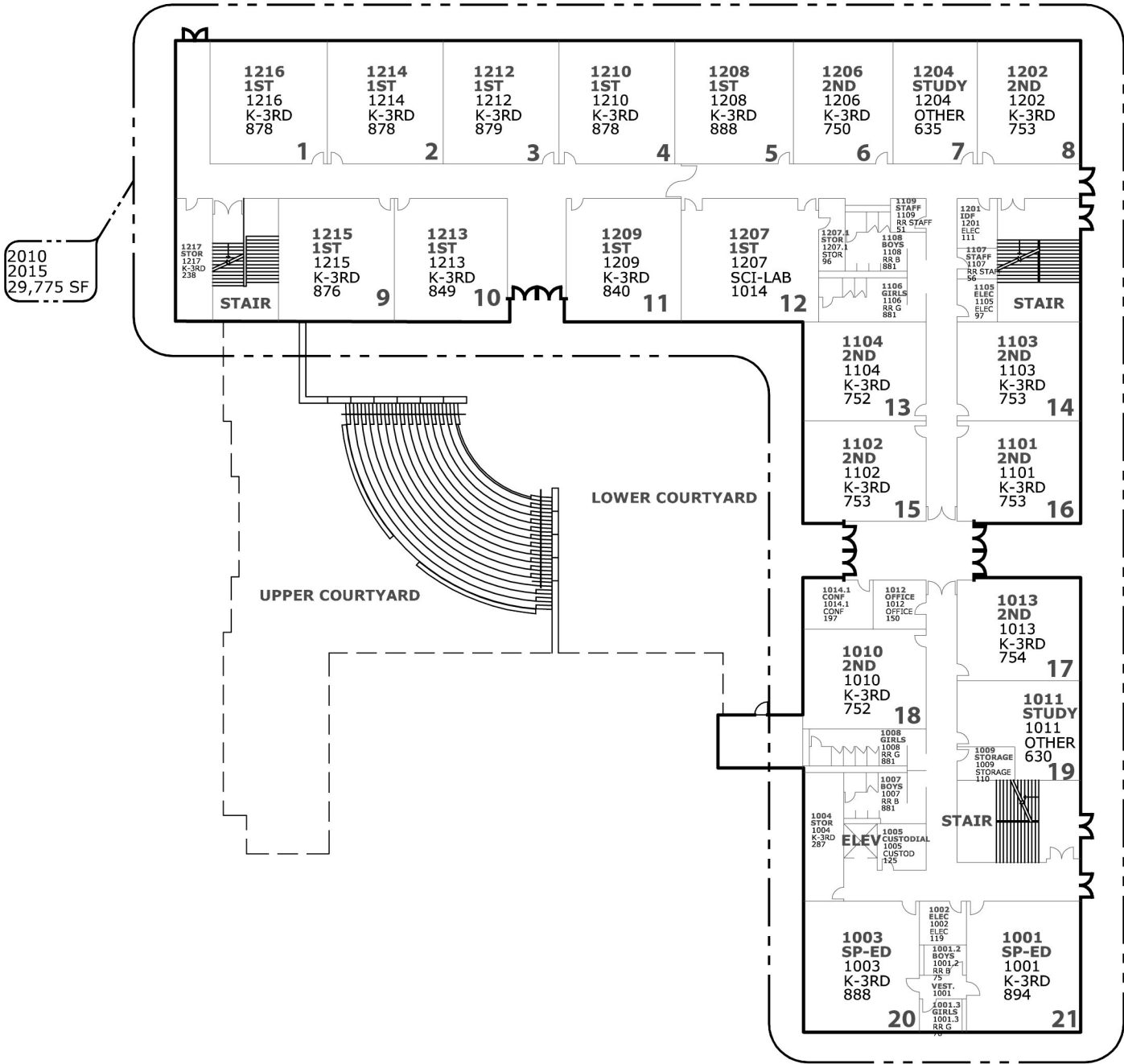

LOWER LEVEL FLOOR PLAN
NOT TO SCALE



DCSD Capacity



New Prototype Elementary School Capacity Report as Designed

R-#	Room Type	Students Per Room	Facility		Portable Classrooms	Total (Facility + Portables)	
Elementary Schools			Room Count	Student Capacity	Portable Count	Room Count	Student Capacity
R01	Pre-school	22	1	22	0	1	22
R02	Kindergarten	24	10	240	0	10	240
R03	General classroom grades 1-3	27	22	594	0	22	594
R04	General classroom grades 4-5	31	12	372	0	12	372
R05	K-5 Gifted - self-contained	25	0	0	0	0	0
R06	K-5 Early Intervention (EIP) self-contained - Level 1	22	0	0	0	0	0
R07	K-5 Special Education self-contained - severe and profound	8	0	0	0	0	0
R08	PK-5 Special Education self-contained - other	10	2	20	0	2	20
R09	K-3 ESOL - self-contained	15	0	0	0	0	0
R10	4-5 ESOL - self-contained	18	0	0	0	0	0
R11	K-5 Resource - Pull out (EIP, Gifted, SPED, ESOL) & Other	0	8	0	0	8	0
R12	K-5 Science/STEM	0	1	0	0	1	0
R13	K-5 Computer Lab (ESOL computer lab)	0	1	0	0	1	0
R14	K-5 Music/Band/Strings	0	1	0	0	1	0
R15	K-5 Art	0	1	0	0	1	0
R16	K-5 Physical Education	0	1	0	0	1	0
R17	K-5 Media Center	0	1	0	0	1	0
R17.1	K-5 Non-Instructional Use	26	0	0	0	0	0
	<i>Total</i>		61	1248	0	61	1248
	<i>Scheduling Factor</i> <i>(Reduction of total to account for the number of periods the room is not used and allow for rounding of teacher allotments)</i>			0.85			0.85

Capacity

(Total x Scheduling Factor)

1061

1061

Facility Room Count / Total

(ratio of facility rooms to total rooms)

x

1

DCSD Capacity

1061

FTE Mid-Range Capacity

(Based on GaDOE tables)

950

Principal Signature:	
Prepared by:	David Yoke, Planning & GIS Analyst

DSCD Capacity



New Prototype Elementary School Capacity Report as Used

R-#	Room Type	Students Per Room	Facility		Portable Classrooms	Total (Facility + Portables)	
Elementary Schools			Room Count	Student Capacity	Portable Count	Room Count	Students Capacity
R01	Pre-school	22	2	44	0	2	44
R02	Kindergarten	24	7	168	0	7	168
R03	General classroom grades 1-3	27	15	405	0	15	405
R04	General classroom grades 4-5	31	8	248	0	8	248
R05	K-5 Gifted - self-contained	25	6	150	0	6	150
R06	K-5 Early Intervention (EIP) self-contained - Level 1	22	6	132	0	6	132
R07	K-5 Special Education self-contained - severe and profound	8	2	16	0	2	16
R08	PK-5 Special Education self-contained - other	10	2	20	0	2	20
R09	K-3 ESOL - self-contained	15	0	0	0	0	0
R10	4-5 ESOL - self-contained	18	0	0	0	0	0
R11	K-5 Resource - Pull out (EIP, Gifted, SPED, ESOL) & Other	0	7	0	0	7	0
R12	K-5 Science/STEM	0	1	0	0	1	0
R13	K-5 Computer Lab (ESOL computer lab)	0	1	0	0	1	0
R14	K-5 Music/Band/Strings	0	1	0	0	1	0
R15	K-5 Art	0	1	0	0	1	0
R16	K-5 Physical Education	0	1	0	0	1	0
R17	K-5 Media Center	0	1	0	0	1	0
R17.1	K-5 Non-Instructional Use	26	0	0	0	0	0
Total			61	1183	0	61	1183
Scheduling Factor <i>(Reduction of total to account for the number of periods the room is not used and allow for rounding of teacher allotments)</i>				0.85			0.85

Capacity

(Total x Scheduling Factor)

1006

1006

Facility Room Count / Total

(ratio of facility rooms to total rooms)

x

1

DCSD Capacity

1006

FTE Mid-Range Capacity

(Based on GaDOE tables)

950

Principal Signature:	
Prepared by:	David Yoke, Planning & GIS Analyst

DeKalb County School District

Official Capacity Report - ES



5116 Barack Obama Elementary Magnet School of Technology Facility

Grades Served:

PK-5

Room Category	Room Count	Students/Rm	Capacity
R01: Pre-school:	2.00	22	44
R02: Kindergarten:	9.00	24	216
R03: General Classroom Grades 1-3:	23.00	27	621
R04: General Classroom Grades 4-5:	13.00	31	403
R05: K-5 Gifted - Self-Contained:	0.00	23	0
R06: K-5 Early Intervention (EIP) Self-Contained - Level 1:	0.00	22	0
R07: K-5 Special Education Self- Contained - Severe and Profound:	0.00	8	0
R08: PK-5 Special Education Self-Contained - Other:	2.00	10	20
R09: K-3 ESOL - Self-Contained:	0.00	15	0
R10: 4-5 ESOL - Self-Contained:	0.00	18	0
R11: K-5 Resource - Pull Out (EIP, Gifted, SPED, ESOL):	6.00	0	0
R12: K-5 Science/STEM:	1.00	0	0
R13: K-5 Computer Lab (ESOL Computer Lab):	1.00	0	0
R14: K-5 Music/Band/Strings:	1.00	0	0
R15: K-5 Art:	1.00	0	0
R16: K-5 Physical Education:	1.00	0	0
R17: K-5 Media Center:	1.00	0	0
R17.1: K-5 Non-Instructional Use:	0.00	26	0
Total:	61.00		1,304
Scheduling Factor:		X	85%
Total Capacity - Instructional Space Model:		=	1,108
Adjustments (to account for over/under utilized space):		+	-22
Total Capacity - Instructional Space Model:		=	1,086

*Barack H. Obama ES capacity report has not been updated for 2019- 2020 year as of 10/15/2019.

DeKalb County School District

Offical Capacity Report - ES



Fernbank Elementary Facility Capacity Report

R-#	Room Type	Students Per Room	Facility		Portable Classrooms	Total (Facility + Portables)	
Elementary Schools			Room Count	Student Capacity	Portable Count	Room Count	Student Capacity
R01	Pre-school	22	1	22	0	1	22
R02	Kindergarten	24	3	72	0	3	72
R03	General classroom grades 1-3	27	3	81	0	3	81
R04	General classroom grades 4-5	31	3	93	0	3	93
R05	K-5 Gifted - self-contained	25	26	650	0	26	650
R06	K-5 Early Intervention (EIP) self-contained - Level 1	22	8	176	0	8	176
R07	K-5 Special Education self-contained - severe and profound	8	3	24	0	3	24
R08	PK-5 Special Education self-contained - other	10	0	0	0	0	0
R09	K-3 ESOL - self-contained	15	0	0	0	0	0
R10	4-5 ESOL - self-contained	18	0	0	0	0	0
R11	K-5 Resource - Pull out (EIP, Gifted, SPED, ESOL) & Other	0	7	0	0	7	0
R12	K-5 Science/STEM	0	1	0	0	1	0
R13	K-5 Computer Lab (ESOL computer lab)	0	1	0	0	1	0
R14	K-5 Music/Band/Strings	0	2	0	0	2	0
R15	K-5 Art	0	1	0	0	1	0
R16	K-5 Physical Education	0	1	0	0	1	0
R17	K-5 Media Center	0	1	0	0	1	0
R17.1	K-5 Non-Instructional Use	26	0	0	0	0	0
	<i>Total</i>		61	1,118	0	61	1,118
	<i>Scheduling Factor</i> (Reduction of total to account for the number of periods the room is not used and allow for rounding of teacher allotments)			85%			85%
	<i>Capacity</i> (Total x Scheduling Factor)			950			950
	<i>Facility Room Count / Total</i> (ratio of facility rooms to total rooms)					x	1.00

DCSD Capacity

950

* R05 Students per room erroneously reported as 23 on previous years report.

Facility FTE Capacity

(Mid-Range Capacity Based on GaDOE tables)

950

Principal Signature:

Prepared by: David Yoke, Planning & GIS Analyst

DeKalb County School District

Official Capacity Report - ES



John Lewis Elementary Facility Capacity Report

R-#	Room Type	Students Per Room	Facility		Portable Classrooms	Total (Facility + Portables)	
Elementary Schools			Room Count	Student Capacity	Portable Count	Room Count	Student Capacity
R01	Pre-school	22	2	44	0	2	44
R02	Kindergarten	24	7	168	0	7	168
R03	General classroom grades 1-3	27	14	378	0	14	378
R04	General classroom grades 4-5	31	12	372	0	12	372
R05	K-5 Gifted - self-contained	25	0	0	0	0	0
R06	K-5 Early Intervention (EIP) self-contained - Level 1	22	5	110	0	5	110
R07	K-5 Special Education self-contained - severe and profound	8	0	0	0	0	0
R08	PK-5 Special Education self-contained - other	10	4	40	0	4	40
R09	K-3 ESOL - self-contained	15	0	0	0	0	0
R10	4-5 ESOL - self-contained	18	0	0	0	0	0
R11	K-5 Resource - Pull out (EIP, Gifted, SPED, ESOL) & Other	0	8	0	0	8	0
R12	K-5 Science/STEM	0	1	0	0	1	0
R13	K-5 Computer Lab (ESOL computer lab)	0	1	0	0	1	0
R14	K-5 Music/Band/Strings	0	2	0	0	2	0
R15	K-5 Art	0	1	0	0	1	0
R16	K-5 Physical Education	0	1	0	0	1	0
R17	K-5 Media Center	0	1	0	0	1	0
R17.1	K-5 Non-Instructional Use	26	2	52	0	2	52
	Total		61	1,164	0	61	1,164
	Scheduling Factor <i>(Reduction of total to account for the number of periods the room is not used and allow for rounding of teacher allotments)</i>			85%			85%
	Capacity <i>(Total x Scheduling Factor)</i>			989			989
	Facility Room Count / Total <i>(ratio of facility rooms to total rooms)</i>					x	1.00

DCSD Capacity

989

* R05 Students per room erroneously reported as 23 on previous years report.

Facility FTE Capacity

(Mid-Range Capacity Based on GaDOE tables)

950

Principal Signature:

Prepared by: David Yoke, Planning & GIS Analyst

DeKalb County School District

Official Capacity Report - ES



5416 Peachcrest Elementary Facility

Grades Served:

PK-5

Room Category	Room Count	Students/Rm	Capacity
R01: Pre-school:	2.00	22	44
R02: Kindergarten:	9.00	24	216
R03: General Classroom Grades 1-3:	23.00	27	621
R04: General Classroom Grades 4-5:	13.00	31	403
R05: K-5 Gifted - Self-Contained:	0.00	23	0
R06: K-5 Early Intervention (EIP) Self-Contained - Level 1:	0.00	22	0
R07: K-5 Special Education Self- Contained - Severe and Profound:	0.00	8	0
R08: PK-5 Special Education Self-Contained - Other:	2.00	10	20
R09: K-3 ESOL - Self-Contained:	0.00	15	0
R10: 4-5 ESOL - Self-Contained:	0.00	18	0
R11: K-5 Resource - Pull Out (EIP, Gifted, SPED, ESOL):	6.00	0	0
R12: K-5 Science/STEM:	1.00	0	0
R13: K-5 Computer Lab (ESOL Computer Lab):	1.00	0	0
R14: K-5 Music/Band/Strings:	1.00	0	0
R15: K-5 Art:	1.00	0	0
R16: K-5 Physical Education:	1.00	0	0
R17: K-5 Media Center:	1.00	0	0
R17.1: K-5 Non-Instructional Use:	0.00	26	0
Total:	61.00		1,304
Scheduling Factor:		X	85%
Total Capacity - Instructional Space Model:		=	1,108
Adjustments (to account for over/under utilized space):		+	-22
Total Capacity - Instructional Space Model:		=	1,086

*Peachcrest ES capacity report has not been updated for 2019- 2020 year as of 10/15/2019.

DeKalb County School District

Official Capacity Report - ES



272 Rockbridge Elementary Facility

Grades Served:

PK-5

Room Category	Room Count	Students/Rm	Capacity
R01: Pre-school:	2.00	22	44
R02: Kindergarten:	8.00	24	192
R03: General Classroom Grades 1-3:	20.00	27	540
R04: General Classroom Grades 4-5:	12.00	31	372
R05: K-5 Gifted - Self-Contained:	0.00	23	0
R06: K-5 Early Intervention (EIP) Self-Contained - Level 1:	0.00	22	0
R07: K-5 Special Education Self- Contained - Severe and Profound:	2.00	8	16
R08: PK-5 Special Education Self-Contained - Other:	4.00	10	40
R09: K-3 ESOL - Self-Contained:	0.00	15	0
R10: 4-5 ESOL - Self-Contained:	0.00	18	0
R11: K-5 Resource - Pull Out (EIP, Gifted, SPED, ESOL):	7.00	0	0
R12: K-5 Science/STEM:	1.00	0	0
R13: K-5 Computer Lab (ESOL Computer Lab):	1.00	0	0
R14: K-5 Music/Band/Strings:	1.00	0	0
R15: K-5 Art:	1.00	0	0
R16: K-5 Physical Education:	1.00	0	0
R17: K-5 Media Center:	1.00	0	0
R17.1: K-5 Non-Instructional Use:	0.00	26	0
Total:	61.00		1,204
Scheduling Factor:		X	90%
Total Capacity - Instructional Space Model:		=	1,084
Adjustments (to account for under/over utilized space):		+	
Total Capacity - Instructional Space Model:		=	1,084

*Rockbridge ES capacity report has not been updated for 2019- 2020 year as of 10/15/2019.